



VACUUM / HYDRAULIC TRAILER KITS

The TV series vacuum / hydraulic trailer kits are designed to meet the fluid displacement and pressure requirements of a wide variety of axle capacities. All kits listed below are furnished complete with control valve, vacuum tank, vacuum / hydraulic actuator, vacuum hose and hydraulic brake line kit. The chart below provides an easy way to select the proper kit for a particular application by referencing the axle manufacturer and axle size. Torsion axle kits are also available.

Custom Kits are Available



AXLE MANUFACTURER	AXLE SET-UP		TRAILER KIT SELECTION		
	AXLE RATING	BRAKE TYPE	SINGLE AXLE	TANDEM AXLE	TRIPLE AXLE
DEXTER	5K-7K	DRUM	TV-801	TV-802	TV-803
	8K-12K	DRUM	TV-1001	TV-1002	TV-1003
	15K	DRUM	TV-1001	TV-1002	TV-1003-2
	10K, 15K	DISC	TV-1601D	TV-1602D	TV-1603D
HAYES	5K-7K	DRUM	TV-801	TV-802	TV-803
	8K	DRUM	TV-1201	TV-1202	TV-1203
	9K, 10K, 12K	DRUM	TV-1601	TV-1602	TV-1603
	10K-12K	DISC	TV-1601D	TV-1602D	TV-1603D

VACUUM / HYDRAULIC BOOSTER TECHNICAL DATA			
KIT SERIES	BOOSTER PART NO.	OUTPUT PRESSURE @ 20 in. Hg INPUT	FLUID DISPLACEMENT
TV-800	VB-800	750 PSIG	4.40 cu. in.
TV-1000	VB-1000	1000 PSIG	3.45 cu. in.
TV-1200	VB-1200	1200 PSIG	2.45 cu. in.
TV-1600	VB-1600	1600 PSIG	2.20 cu. in.

NOTE: the number of boosters required depends on the brakes, the number of axles and the booster fluid capacity.

WARNING: It is the brake system installers' responsibility to ensure compatibility between towing vehicle and trailer actuation systems. Various combinations of air/hyd. Or vacuum/hyd. And tow vehicle systems can allow normal maximum working pressure to exceed 1000 psi on drum brakes. Pressures in excess of 1000 psi on drum brakes increase lining wear and can lead to component failure. Make certain your system has the correct boost ratio and brake fluid volume to activate brakes properly.



TYPICAL SYSTEM

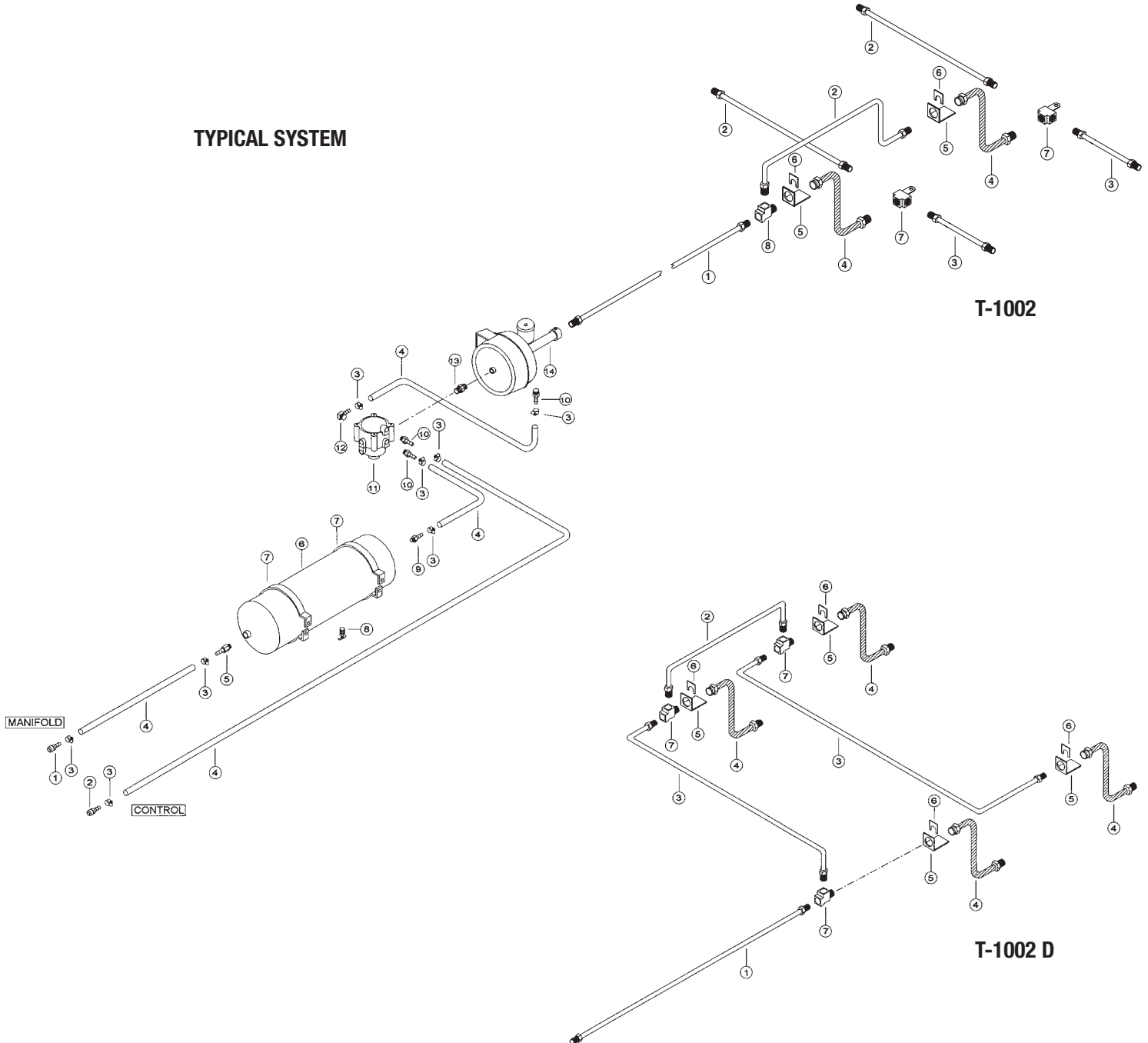

T-1002

T-1002 D